

KOBRA 240 C4 Turbo

CLASSIC LINE SHREDDER
PERSONAL USE AND SMALL/MEDIUM OFFICES



Model: KOBRA 240 C4 TURBO
Article code: 99.741 TURBO
EAN Code: 8 026064 997416



Throat width:	9.5 inch
Shred size:	1/8 x 1 1/8 inch cross cut
Security level ISO/IEC 21964 (DIN 66399):	P-4 O-3 T-4 E-3 F-1
Paper capacity* (sheets at a time):	up to 26 sheets
Shreddable materials:	Paper, Credit cards, Smart cards, CDs/DVDs, Floppy-disks, Films
Waste bag volume:	9.5 gal
Speed:	7 ft/min
Noise level:	61 dB(A)
Voltage:	115 Volt / 60 Hz
Power:	3/4 HP
Dimensions (WxDxH):	14.5 x 13 x 22 inch
Weight:	31 lbs – Packaging: 1 unit per box

Datasheet n.29 rev.1

* Capacity varies based on supply power, weight, quality and grain of paper, operating temperature and blade lubrication.

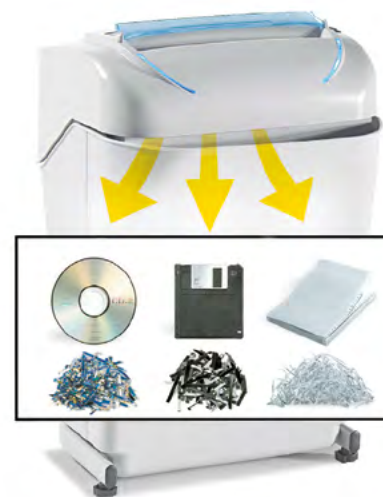

Certifications:  **CB CE**

Trade Agreement Act (TAA) and Buy American Act Compliant

MAIN FEATURES

Cross-cut shredder equipped with heavy duty chain drive system with metal gears. Kobra 240 C4 TURBO featuring the "Turbo Boost System" for extra-shredding capacity can shred up to 26 sheets in one pass and eliminate paper jams. Carbon hardened cutting knives unaffected by staples and clips.

Motor thermal protection: 24 hour continuous duty operations without overheating or duty cycles. Energy Smart System with optical illuminated indicators for power saving stand-by mode and environmental protection. Equipped with a removable waste bin for easy empty operations, does not require lifting of the cutting head.

- **Turbo Boost System:** by pressing the Turbo switch the shredding capacity of the machine is increased by 30%
- **Super Potential Power Unit:** heavy duty chain drive system with steel gears
- **Continuous duty shredding:** 24 hour continuous duty motor without overheating and duty cycles. Motor thermal protection.
- **Carbon hardened steel cutting knives** unaffected by staples and clips
- **Energy Smart System:** power saving stand-by mode with optical illuminated indicators
- **Start & Stop:** automatic start and stop through electronic eyes with stand-by function
- **Safety Stop:** automatically stops at bin removal
- **35 litre removable waste bin** for easy empty operations: does not require lifting the cutting head. Equipped with a mechanism to separate shredded paper from plastic shreds. **Eco-friendly:** does not require plastic bags.



24 HOUR CONTINUOUS DUTY MOTOR

Motor thermal protection. Continuous duty motor, no overheating and no duty cycles. Optical illuminated indicators for power saving stand-by mode.



SUPER POTENTIAL POWER UNIT

Heavy duty chain drive with steel gears which offer reliability and resistance to wear. Carbon hardened steel cutting knives unaffected by staples and clips.



TURBO BOOST SYSTEM

by pressing the Turbo switch the shredding capacity of the machine is increased by 30%.



CONVENIENT REMOVABLE WASTE BIN

for easy empty operations: does not require lifting the cutting head. Equipped with a mechanism to separate shredded paper from plastic shreds.