

# KOBRA 240 C4 Turbo

CLASSIC LINE SHREDDER  
PERSONAL USE AND SMALL/MEDIUM OFFICES

Manufacturer: ELCOMAN srl  
Brand: KOBRA  
Model: KOBRA 240 C4 TURBO  
Article Code: 99.741 TURBO  
EAN Code: 8 026064 997416

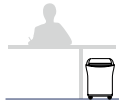

Throat width:	240 mm
Shred size:	3,5 x 30 mm cross cut
Security level ISO/IEC 21964 (DIN 66399):	P-4 O-3 T-4 E-3 F-1
Paper capacity* (sheets at a time):	24-26 sheets (A4 70gr) / 19-21 sheets (A4 80gr)
Shreddable materials:	Paper, Credit cards, Credit cards with chip, CDs/DVDs, Floppy-disks, Film
Waste bin capacity:	35 litres
Speed:	0,028 m/sec
Noise level:	58-61 dB(A)
Voltage:	230 Volt
Power:	460 Watt
Dimensions (WxDxH):	37 x 33 x 56 cm
Weight (net/gross):	17 Kg – Packaging: 1 unit per box

Datasheet n.29 rev.2

\* Capacity varies based on supply power, weight, quality and grain of paper, operating temperature and blade lubrication.

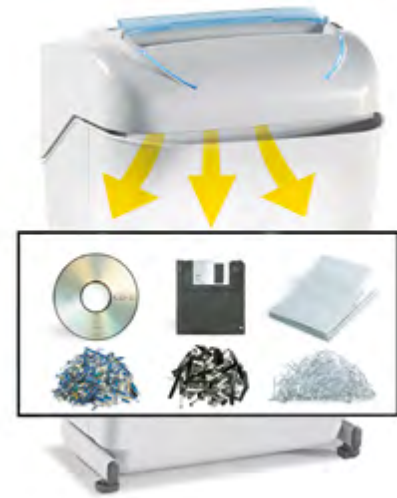

Certifications:

## MAIN FEATURES

Cross-cut shredder equipped with heavy duty chain drive system with metal gears. Kobra 240 C4 TURBO featuring the "Turbo Boost System" for extra-shredding capacity can shred up to 26 sheets in one pass and eliminate paper jams. Carbon hardened cutting knives unaffected by staples and clips.

Motor thermal protection: 24 hour continuous duty operations without overheating or duty cycles. Energy Smart System with optical illuminated indicators for power saving stand-by mode and environmental protection. Equipped with a removable waste bin for easy operations, does not require lifting of the cutting head.

- **Turbo Boost System:** by pressing the Turbo switch the shredding capacity of the machine is increased by 30%
- **Super Potential Power Unit:** heavy duty chain drive system with steel gears
- **Continuous duty shredding:** 24 hour continuous duty motor without overheating and duty cycles. Motor thermal protection.
- **Carbon hardened steel cutting knives** unaffected by staples and clips
- **Energy Smart System:** power saving stand-by mode with optical illuminated indicators
- **Start & Stop:** automatic start and stop through electronic eyes with stand-by function
- **Safety Stop:** automatically stops at bin removal
- **35 litre removable waste bin** for easy empty operations: does not require lifting the cutting head. Equipped with a mechanism to separate shredded paper from plastic shreds. **Eco-friendly:** does not require plastic bags.



### 24 HOUR CONTINUOUS DUTY MOTOR

Motor thermal protection. Continuous duty motor, no overheating and no duty cycles. Optical illuminated indicators for power saving stand-by mode.



### SUPER POTENTIAL POWER UNIT

Heavy duty chain drive with steel gears which offer reliability and resistance to wear. Carbon hardened steel cutting knives unaffected by staples and clips.



### TURBO BOOST SYSTEM

by pressing the Turbo switch the shredding capacity of the machine is increased by 30%.



### CONVENIENT REMOVABLE WASTE BIN

for easy empty operations: does not require lifting the cutting head. Equipped with a mechanism to separate shredded paper from plastic shreds.