

KOBRA 260 S5

CLASSIC LINE SHREDDER
FOR MEDIUM SIZED OFFICES

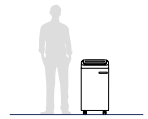

Model: KOBRA 260 S5
Article Code: 99.516
EAN Code: 8 026064 995160



Throat width:	10.25 inch
Shred size:	1/4 inch straight cut
Security level ISO/IEC 21964 (DIN 66399):	P-2 O-2 T-2 E-2
Paper capacity* (sheets at a time):	up to 31 sheets
Shreddable materials:	Paper, Credit cards, Credit cards with chip, CDs/DVDs, Floppy-disks
Waste bag volume:	22 gal
Speed:	24 ft/min
Noise level:	55 dB(A)
Voltage:	115 Volt / 60 Hz
Power:	3/4 HP
Dimensions (WxDxH):	17 x 12.25 x 32.5 inch
Weight:	57 lbs

Datasheet n.37 rev.0

* Capacity varies on supply power, weight, quality and grain of paper,
operating temperature and blade lubrication

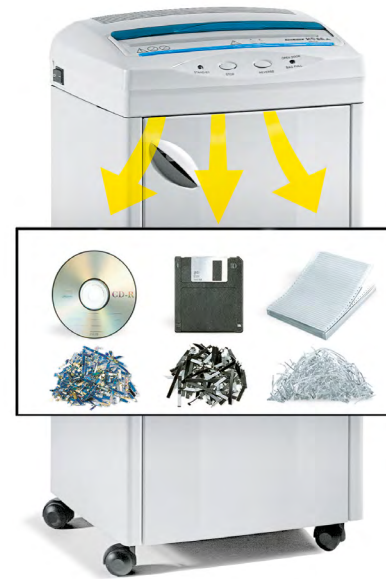

Certifications   

Trade Agreement Act (TAA) Compliant

MAIN FEATURES

Straight-cut shredder with high quality steel cabinet mounted on casters. Equipped with heavy duty chain drive system with metal gears and carbon hardened cutting knives unaffected by staples and clips. Kobra 260 S5 can shred up to 31 sheets at a time, CDs/DVDs, credit cards and floppy-disks. Motor thermal protection: 24 hour continuous duty operations without overheating or duty cycles. Energy Smart System for the environmental protection and energy cost saving: light indicators are turned on while the machine is shredding and switched off for zero consumption.

- **Super Potential Power Unit:** heavy duty chain drive system with steel gears
- **Continuous duty shredding:** 24 hour continuous duty motor without overheating and duty cycles
- **Carbon hardened steel cutting knives** unaffected by staples and clips
- **Energy Smart System:** with optical indicators for power saving stand-by mode
- **Oil-free System:** no need of lubrication and maintenance of cutting knives
- **Start & Stop:** automatic start and stop through electronic eyes with stand-by function
- **Safety Stop:** automatically stops at open door and/or full waste bin
- **Automatic Reverse System** in case of jamming
- **High quality steel cabinet** mounted on casters, easy to empty 22 gallon collection bag

ACCESORIES AND CONSUMABLE MATERIALS:

Plastic waste bags (50 pcs/box, art. code SB-30) – Top shelf (art. code SH-260)

24 HOUR CONTINUOUS DUTY MOTOR

Motor thermal protection.
Continuous duty motor, no
overheating and no duty cycles.



ENERGY SMART SYSTEM

Power management system with
illuminated indicators for power
saving in stand-by mode.



CARBON HARDENED STEEL CUTTING KNIVES

unaffected by staples and clips. Oil-
free System: no need of lubrication
and maintenance of cutting knives.

OPTION



DOCUMENT TOP SHELF

Document top shelf to save office
space (space saving design).